

**PHILIPS**

**EasyKey**

**5100**

Rim  
Smart Door Lock

# User manual

Register products and get  
support on the following site

[www.philips.com/support](http://www.philips.com/support)



# Contents

<b>1 Important information</b>	<b>02</b>	<b>5 How to use your EasyKey</b>	<b>16</b>
Security		Unlock	
Caution		<b>Outside Unlocking</b>	
Disposal of used products and batteries		-With a PIN code	
		-With a fingerprint	
		-With a card	
		<b>Inside Unlocking</b>	
		-With rotary knob	
		-With CLOSE button	
		<b>Lock</b>	
		<b>Auto/Manual modes</b>	
		-Outside locking	
		-Inside locking	
<b>2 Install your EasyKey</b>	<b>03</b>	<b>6 Other functions</b>	<b>18</b>
Packaging list		Restore to factory settings	
Exploded views		One-button mute function	
Pre-installation instructions		Outside forced lock function	
Installation steps		Inside deadlock	
<b>3 Get to know your EasyKey</b>	<b>07</b>	<b>7 Meanings &amp; Use of indicators</b>	<b>20</b>
Outside escutcheon		Door status indicator	
Inside escutcheon		Low battery indicator	
		Outside forced lock indicator	
		Mute mode indicator	
<b>4 How to set up your EasyKey</b>	<b>08</b>	<b>8 Troubleshooting</b>	<b>22</b>
Pre-setup instructions		Alarm types and alarm modes	
How to set up your EasyKey under Security Mode		How to apply an emergency power	
-Modify Master PIN code		How to replace batteries	
-User settings			
-Delete a user			
-System settings			
-Extended functions			
How to set up your EasyKey under General mode			
-User settings			
-Delete a user			
-System settings			
-Extended functions			
-System query			

# 1 Important information

## Security

◆Before using Philips EasyKey, please read and understand all instructions. Damage caused by non-compliance with the instructions will not be covered by warranty.

◆Use only the manufacturer-specified accessories/components.

◆Use only the alkaline batteries the product is equipped with, or use the same specification type of alkaline batteries.

◆Do not forcibly disassemble this product to avoid triggering an alarm or damaging the product.

◆Do not scrape the fingerprint sensor with sharp objects, otherwise it may cause permanent damage.

◆Do not expose products to environments where there is water leakage or splashing.

◆Do not expose the product to corrosive substances to prevent damaging the protective cover.

◆Do not hang objects on the handle, in case it might affect the normal use of the lock.

◆Please clean the product with a soft cloth.

◆Do not remove the battery during setting up and operating.

◆Please let a professional technician to install the door lock and follow the installation guidelines provided. Do not disassemble the lock by yourself. Keep the relevant sealed stickers properly. Do not easily disclose the password information.

◆Please modify the default master PIN code immediately after finishing installing and debugging, and keep the mechanical key properly.

◆Please replace all the batteries immediately if there is a low battery alarm. Please make sure to correctly match the poles (+/-) when installing the batteries.

## Caution

◆Do not place the battery near fire sources to avoid explosion.

◆Do not use any emergency power supply that does not meet the safety requirements to power up the product.

◆Do not connect the 2 poles of the batteries with metals to avoid short circuit which may lead to an explosion.

◆Please make sure any component replacement is executed by Philips, Philips authorized service center or professional technicians.

◆Do not use accessories or parts that have been produced by other manufacturers or have not been specifically recommended by Philips. The use of such accessories and parts may void your warranty.

## Disposal of used products and batteries

◆You can have your locks reclaimed at Philips authorized service centers. You will receive corresponding compensation if your products meet our conditions.

◆Please familiarize yourself with the local electronic product collection system.

◆Please follow local regulations and do not discard used products into ordinary household waste.

◆Proper disposal of used products can help to avoid potential negative impacts on the environment and human health.

◆Batteries must not be disposed of with ordinary household waste.

◆Please familiarize yourself with the local regulations on batteries classification recycling. Disposing of batteries properly can help avoid a negative impact on the environment and human health.

# 2 Install your EasyKey

## Packaging list

This packaging list is for reference only. Please refer to the actual packaging contents.

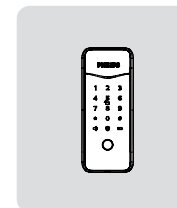

①Outside escutcheon (including silicone pad)

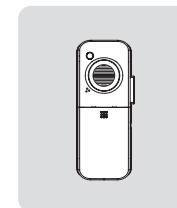

②Inside escutcheon (including silicone pad)

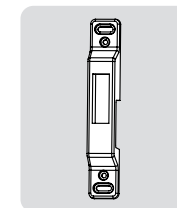

③Striker

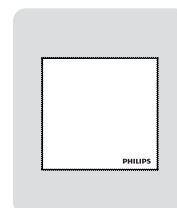

④Cleaning Pad

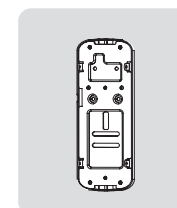

⑤Mounting plate

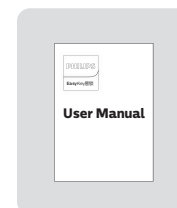

⑥User manual



⑦QSG

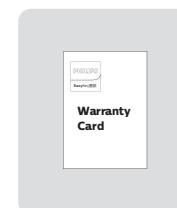

⑧Warranty card



⑨Certificate of Conformity

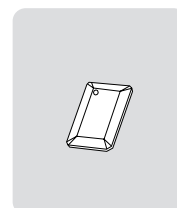

⑩Smart key card x2

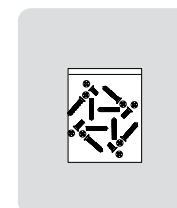

⑪Installation kit



⑫Batteries

## Exploded views

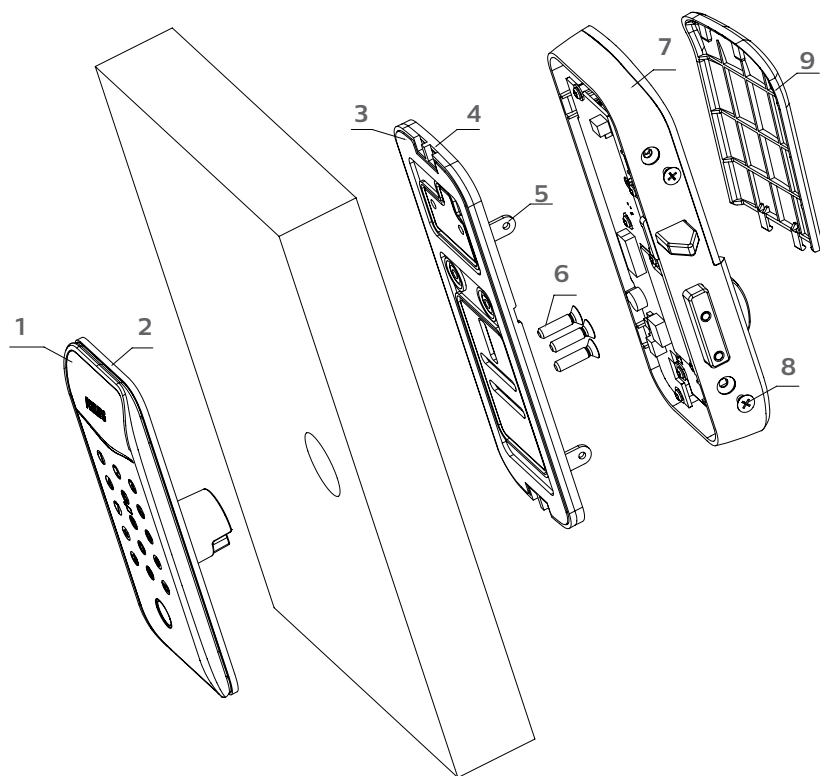

- |   |                            |                                 |
|---|----------------------------|---------------------------------|
| 1. Outside escutcheon (x1)              | 4. Inner plastic pad (x1)  | 7. Inside escutcheon (x1)       |
| 2. Outside escutcheon silicone pad (x1) | 5. Mounting plate (x1)     | 8. M4X6 chamfer head screw (x4) |
| 3. Inside escutcheon silicone pad (x1)  | 6. M5 flat-head screw (x3) | 9. Battery cover (x1)           |

## Pre-installation instruction

### Step 1 | Check the door opening direction

This product can be installed on doors of 4 opening directions: left-out pull, right-in push, right-out pull and left-in push.

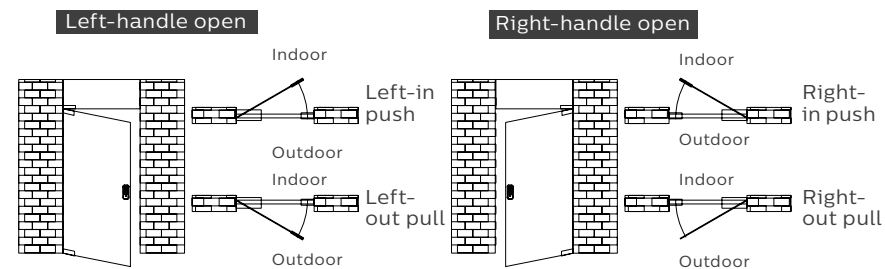

### Step 2 Effects of various door opening directions

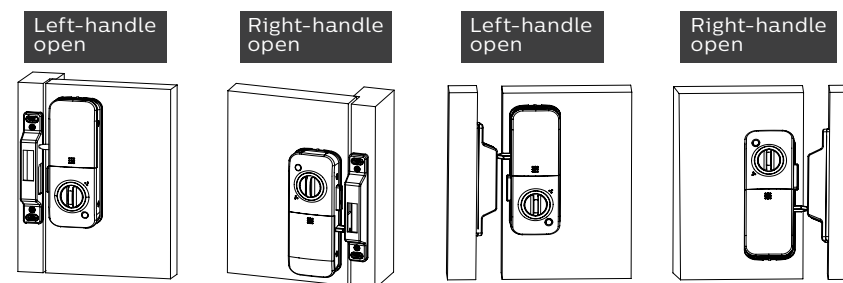

### Step 3 | Select the correct drilling template according to the door opening direction

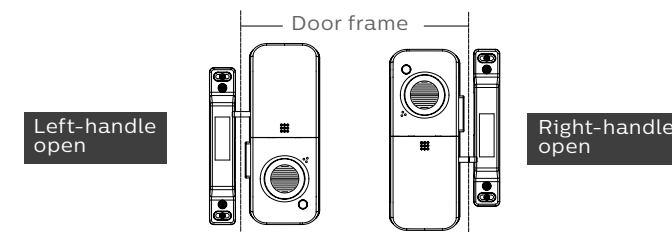

## Installation steps

The following installation steps apply to right -handle opening. If your door is left-handle opening, please turn the inside escutcheon upside down.

- 1 Pass the connecting cable of the outside escutcheon through the door hole.
- 2 Fix the mounting plate with screws.

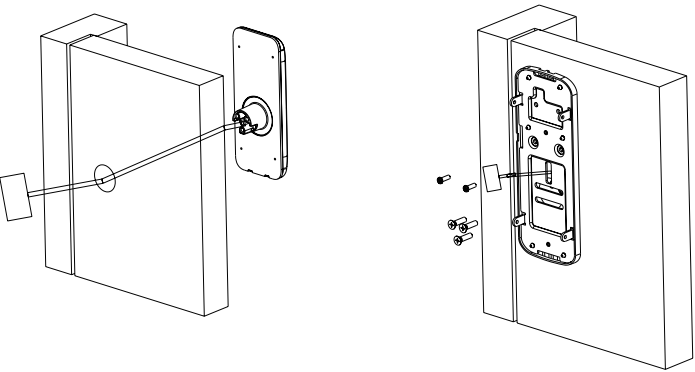

- 3 Insert the cable into the inside escutcheon.
- 4 Fix the inside escutcheon with screws.
- 5 Fix the striker with screws.

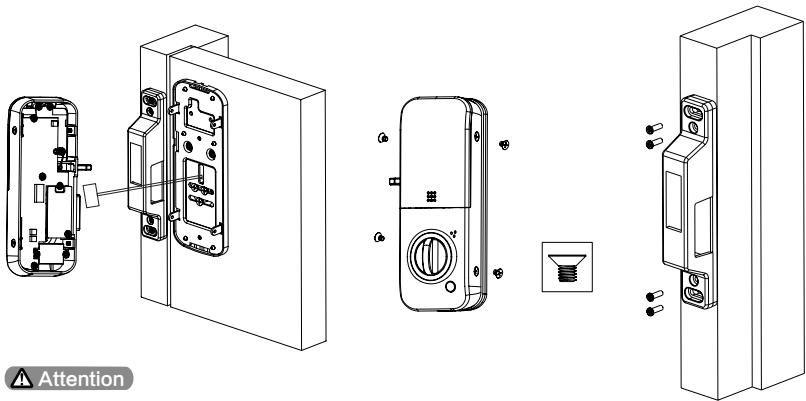

### ⚠ Attention

Please make sure to hide the extra cable in the door hole.

## 3 Get to know your EasyKey

### Outside escutcheon

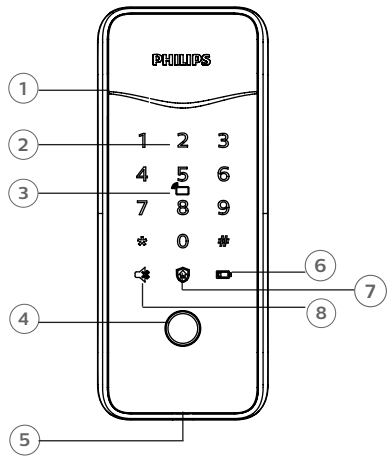

1	Door status indicator
2	Keypad
3	Card reader area
4	Fingerprint sensor
5	Emergency power interface
6	Low battery indicator
7	Outside forced lock button
8	Mute button

### Inside escutcheon

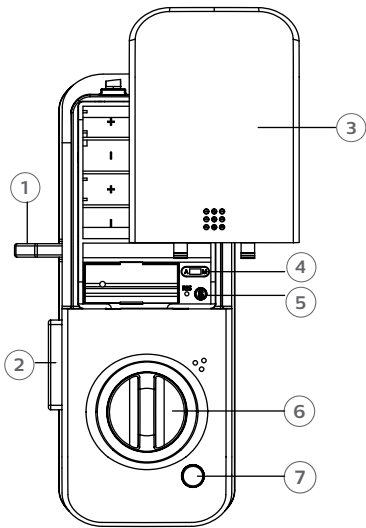

1	Sensor latch bolt
2	Main dead bolt
3	Battery cover
4	Auto/Manual mode switch
5	Settings
6	Rotary knob
7	Close button

## 4 How to set up your EasyKey

### Pre-setup Instructions

There are 2 modes in the EasyKey:

- ◆ Security mode and General mode. Security mode is the default mode.
- ◆ Differences between security mode and general mode:

	Security mode	General mode
Master PIN code	Yes	No
	Default master PINcode:123456789	
User PIN code	10	1
	6-12 digits	4-12 digits
	Number "00-09"	No number
How to enter Master mode	Enter master PIN code	Enter user PIN code
One-time user PIN	1	1
Visitor PIN code	None	1
Number of fingerprints	100	100
	Number "00-99"	No number
Number of smart cards	100	100
	Number "00-99"	No number

#### ⚠ Attention

When switching between Security mode and General mode, all registered user data will be emptied.

#### ◆ User Number

Under the Security mode, numbering the user is required when registering PIN codes, fingerprints and cards. You can delete a single user information by numbers.

◆ You can record the user information in the following table for future query.

Number	Name	Fingerprint	PIN Code	Card
00				
01				
02				
03				
04				
05				
06				
07				
08				
09				

#### ◆ Icon annotation

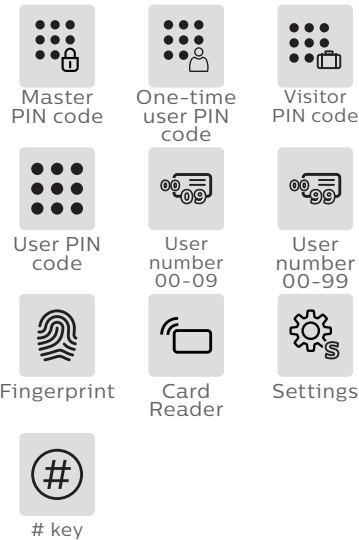

#### ⚠ Attention

1. Before entering the master mode, please make sure the door is unlocked.
2. Please press the [S] button before and after setup to avoid misoperation.
3. Press [\*] to return to the previous menu.

#### ◆ How to enter master mode

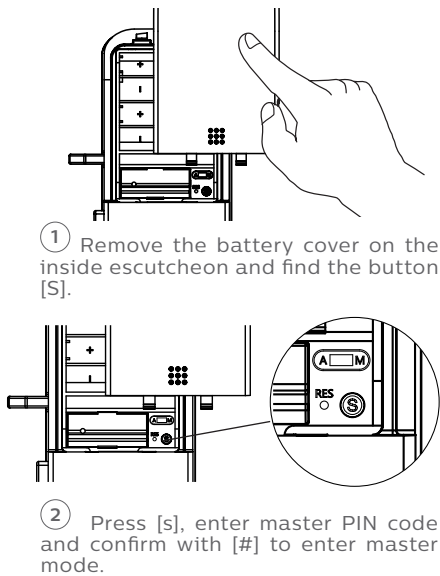

## How to set up your EasyKey under Security mode

### Modify Master PIN code



Press [s], enter master PIN code and confirm with [#].

1

Press [1] to modify Master PIN code.



Enter a new Master PIN code and confirm with [#]. Re-enter the new master PIN code and confirm with [#]. After hearing a voice prompt of "Succeeded", press [S] to exit.

### User settings

#### Register a User PIN code



Press [s], enter master PIN code and confirm with [#].

2 1

Press [2] to enter user settings, then press [1] to register a new User PIN code.



Enter a 2-digit user number (00-09) and confirm with [#].



Enter a User PIN code of 6 to 12 digits and confirm with [#]. Re-enter the User PIN code and confirm with [#]. After hearing a voice prompt of "Succeeded", press [S] to exit.

### Register a fingerprint



Press [s], enter master PIN code and confirm with [#].



Press [2] to enter user settings, then press [2] again to enter fingerprint registration.



Enter a 2-digit user number (00-99) and confirm with [#].



Place your finger against the sensor. After hearing a voice prompt of “Take away your finger and enroll again”, please take away your finger and re-place it against the sensor. Repeat the operation for 4 times. After hearing a voice prompt of “Succeeded”, press [s] to exit.

### Register a card



Press [s], enter master PIN code and confirm with [#].



Press [2] to enter user settings, then press [3] to enter card registration.



Enter a 2-digit user number (00-99) and confirm with [#].



Hold the card close to the card reader until you hear a beep. After hearing a voice prompt of “Succeeded”, press [s] to exit.

### Register a one-time user PIN code



Press [s], enter master PIN code and confirm with [#].



Press [2] to enter user settings, then press [4] to enter one-time PIN code registration.



Enter a one-time user PIN code of 6 to 12 digits and confirm with [#]. Re-enter the PIN code and confirm with [#]. After hearing a voice prompt of “Succeeded”, press [s] to exit.

## Delete a user

### Delete a user PIN code



Press [s], enter master PIN code and confirm with [#].



Press [3] to enter user deletion, then press [1] to enter user PIN code deletion.



Enter the 2-digit [user number] (00-09) of the user PIN code that is to be deleted and confirm with [#]. After hearing a voice prompt of “Succeeded”, press [s] to exit.

#### ⚠ Attention

After hearing the voice prompt of “Enter a user number”, you can enter master PIN code to delete all user PIN codes.

### Delete a fingerprint



Press [s], enter master PIN code and confirm with [#].



Press [3] to enter user deletion, then press [2] to enter fingerprint deletion.



Enter the 2-digit [user number] (00-99) of the fingerprint that is to be deleted and confirm with [#]. After hearing a voice prompt of “Succeeded”, press [s] to exit.

#### ⚠ Attention

After hearing the voice prompt of “Enter a user number”, you can enter master PIN code to delete all user fingerprints.

### Delete a card



Press [s], enter master PIN code and confirm with [#].



Press [3] to enter user deletion, then press [3] again to enter card deletion.



Enter the 2-digit [user number] (00-09) of the card that is to be deleted and confirm with [#]. After hearing a voice prompt of “Succeeded”, press [s] to exit.

#### ⚠ Attention

After hearing the voice prompt of “Enter a user number”, you can enter master PIN code to delete all user cards.

### Delete a one-time user PIN code



Press [s], enter master PIN code and confirm with [#].



Press [3] to enter user deletion, then press [4] to enter one-time user PIN code deletion.



Enter master PIN code and confirm with [#]. After hearing a voice prompt of “Succeeded”, press [s] to exit.

### Delete all user information



Press [s], enter master PIN code and confirm with [#].



Press [3] to enter user deletion, then press [5] to empty user information.



Enter master PIN code and confirm with [#]. After hearing a voice prompt of “Succeeded”, press [s] to exit.

## System Settings

### Switch to General mode



Press [s], enter master PIN code and confirm with [#].

4 1

Press [4] to enter system settings, then press [1] for switching to general mode.



Enter a user PIN code of 4 to 12 digits and confirm with [#]; Re-enter the user PIN code and confirm with [#]. After hearing a voice prompt of "Succeeded", press [s] to exit.

### Volume Settings



Press [s], enter master PIN code and confirm with [#].

4 2

Press [4] to enter system settings, then press [2] to enter volume settings.

1 or 2 or 3 

Adjust the volume as needed: For mute mode, press [1]; for lower volume, press [2]; for higher volume, press [3]. After hearing a voice prompt of "Succeeded", press [s] to exit.

### ⚠ Attention

The default volume is "higher volume."

### Language Settings



Press [s], enter master PIN code and confirm with [#].

4 3

Press [4] to enter system settings, then press [3] to enter language settings.

1 or 2 

Adjust the language as needed: For Chinese, press [1]; for English, press [2]. After hearing a voice prompt of "Succeeded", press [s] to exit.

### ⚠ Attention

The default language is English.

## Extended Functions



Press [s], enter master PIN code and confirm with [#].

5

Press [5] to enter extended functions.

1 or 2 

To join a network, press [1]. To exit a network, press [2]. Before setting up the extended functions, please download the Philips EasyKey APP, open the APP and enable Bluetooth function on your mobile phone.

### ⚠ Attention

The extended functions are optional.

## System Query



Press [s], enter master PIN code and confirm with [#].

6

Press [6] to enter system query, then the serial number of this product will be automatically broadcasted.

### ⚠ Attention

To enter 400# is a shortcut for system query.

## How to set up your EasyKey under general mode

### User settings

#### Modify User PIN code



Press [s], enter user PIN code and confirm with [#].

1 1

Press [1] to enter user settings, then press [1] to enter user PIN code modification.



Enter a new user PIN code and confirm with [#]. Re-enter the User PIN code and confirm with [#]. After hearing a voice prompt of "Succeeded", press [s] to exit.

#### Register a fingerprint



Press [s], enter user PIN code and confirm with [#].

1 2

Press [1] to enter user settings, then press [2] to enter fingerprint registration.



Place your finger against the sensor. After hearing a voice prompt of "Take away your finger and enroll again", please take away your finger and re-place it against the sensor. Repeat the operation for 4 times. After hearing a voice prompt of "Succeeded", press [s] to exit.

#### Register a card



Press [s], enter user PIN code and confirm with [#].

1 3

Press [1] to enter user settings, then press [3] to enter card registration.

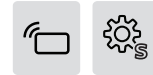

Hold the card close to the card reader until you hear a beep. After hearing a voice prompt of "Succeeded", press [s] to exit.

#### Register a one-time user PIN code



Press [s], enter user PIN code and confirm with [#].

1 4

Press [1] to enter user settings, then press [4] to enter one-time user PIN code registration.



Enter a one-time user PIN code of 4 to 12 digits and confirm with [#]. Re-enter the PIN code and confirm with [#]. After hearing a voice prompt of "Succeeded", press [s] to exit.

#### Register a Visitor PIN code



Press [s], enter user PIN code and confirm with [#].

1 5

Press [1] to enter user settings, then press [5] to enter Visitor PIN code registration.



Enter a Visitor PIN code of 4 to 12 digits and confirm with [#]. Re-enter the PIN code and confirm with [#]. After hearing a voice prompt of "Succeeded", press [s] to exit.

#### ⚠ Attention

Under general mode, you can register a Visitor PIN code. Before deleting the visitor PIN code, it can be used for accessing but cannot be used to enter the master mode.

## Delete User Information

### Delete all fingerprints



Press [s], enter user PIN code and confirm with [#].

2 1

Press [2] to enter user deletion, then press [1] to enter fingerprint emptying.



Enter user PIN code and confirm with [#]. After hearing a voice prompt of "Succeeded", press [s] to exit.

### Delete all cards



Press [s], enter user PIN code and confirm with [#].

2 2

Press [2] to enter user deletion, then press [2] again to empty all cards information.



Enter user PIN code and confirm with [#]. After hearing a voice prompt of "Succeeded", press [s] to exit.

### Delete all one-time user PIN code



Press [s], enter user PIN code and confirm with [#].

2 3

Press [2] to enter user deletion, then press [3] to delete all one-time user PIN codes.



Enter user PIN code and confirm with [#]. After hearing a voice prompt of "Succeeded", press [s] to exit.

### Delete Visitor PIN code



Press [s], enter user PIN code and confirm with [#].

2 4

Press [2] to enter user deletion, then press [4] to enter Visitor PIN code deletion.



Enter user PIN code and confirm with [#]. After hearing a voice prompt of "Succeeded", press [s] to exit.

### Delete all user information



Press [s], enter user PIN code and confirm with [#].

2 5

Press [2] to enter user deletion, then press [5] to enter user information emptying.



Enter user PIN code and confirm with [#]. After hearing a voice prompt of "Succeeded", press [s] to exit.

## System Settings

### Switch to security mode



Press [s], enter user PIN code and confirm with [#].

3 1

Press [3] to enter system settings, then press [1] to enter mode switch.



Enter master PIN code and confirm with [#]. Re-enter master PIN code and confirm with [#]. After hearing a voice prompt of "Succeeded", press [s] to exit.

### Volume Settings



Press [s], enter user PIN code and confirm with [#].

3 2

Press [3] to enter system settings, then press [2] to enter volume settings.

1 or 2 or 3

Adjust the volume as needed: For mute mode, press [1]; For lower volume, press [2]; For higher volume, press [3]. After hearing a voice prompt of "Succeeded", press [s] to exit.

### Language Settings



Press [s], enter user PIN code and confirm with [#].

3 3

Press [3] to enter system settings, then press [3] to enter language settings.

1 or 2

Adjust the language as needed: For Chinese, press [1]; for English, press [2]. After hearing a voice prompt of "Succeeded", press [s] to exit.

## Extended Functions



Press [s], enter master PIN code and confirm with [#].

4

Press [4] to enter extended functions.

1 or 2 

To join a network, press [1]. To exit a network, press [2]. Before setting up the extended functions, please download the Philips EasyKey APP, open the APP and enable Bluetooth function on your mobile phone.

#### Attention

The extended functions are optional.

## System Query



Press [s], enter user PIN code and confirm with [#].

5

Press [5] to enter system query, then the serial number of this product will be automatically broadcasted.

#### Attention

To enter 400# is a shortcut to start system query.

## 5 How to use your EasyKey

### Unlock | Outside Unlocking

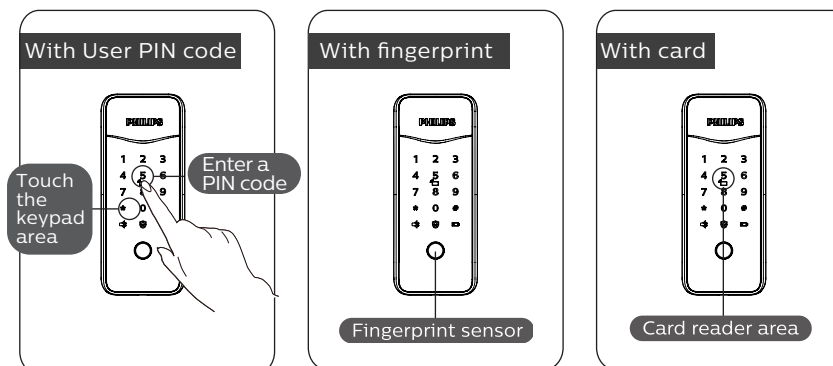

- 1.Touch and wake up the key pad.
- 2.Enter an registered PIN code and confirm with[#].

Directly place the finger of which the fingerprint has been registered on the sensor.

Place the card that has been successfully registered in the card reader area properly.

### Unlock | Inside Unlocking

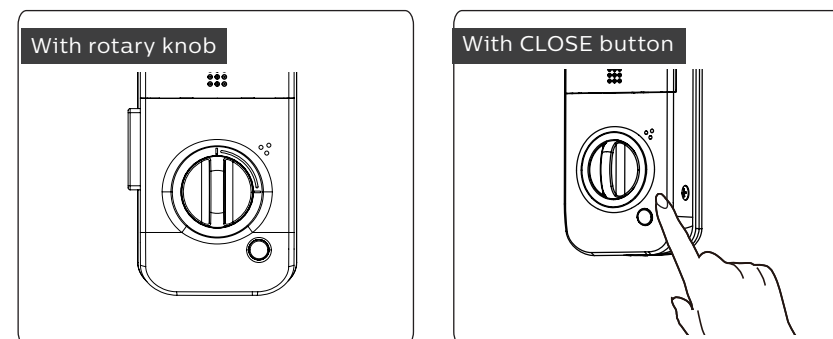

Twist the rotary knob to green scale (as shown above) to unlock.

Press the [Close] button to unlock.

Lock | Auto/Manual modes

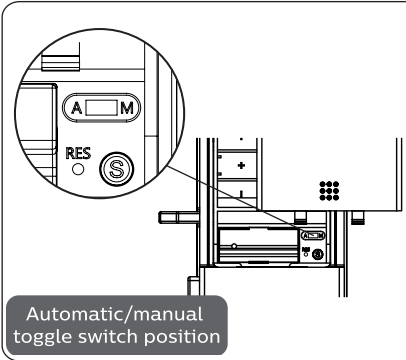

[A] represents automatic mode where the main deadbolt can automatically pop up to get the door locked after closing the door.

[M] represents manual mode where the main deadbolt won't automatically pop up after closing the door and the door will remain open status.

Lock from outside

 When the lock is in auto mode, the deadbolt won't automatically pop up after closing the door, and there will be a voice prompt of "Door closed".

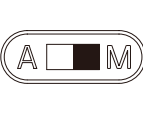
 When the lock is in manual mode, the deadbolt won't automatically pop up after closing the door. Only after a successful verification by fingerprint, PIN code or card can the deadbolt pop up and the door be closed. After the door is successfully locked, there will be a voice prompt of "Door closed".

Lock from inside

 Under auto mode, the deadbolt will automatically pop up after closing the door. There will be a voice prompt of "Door closed".

 Under manual mode, the deadbolt will not pop up automatically after closing the door. You need to press the [Close] button to lock the door. After the door is successfully locked, there will be a voice prompt of "Door closed".

 Under manual mode, the deadbolt will not pop up automatically after closing the door. You need to twist the rotary knob to the red scale (as shown on the left) to lock the door. After the door is successfully locked, there will be a voice prompt of "Door closed".

6 Other functions

Default Settings:One button to restore to factory settings

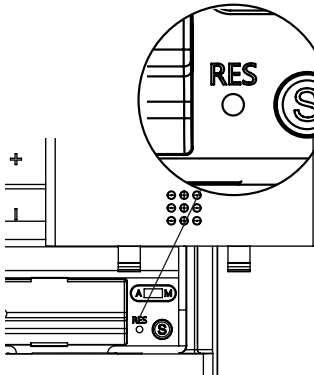

**Function:**  
To empty all user information and restore to factory settings

**Use:**  
Long press the [RES] button for 5 seconds, then all the information in the lock system will be emptied and the lock will be restored to factory settings.

One-button mute function

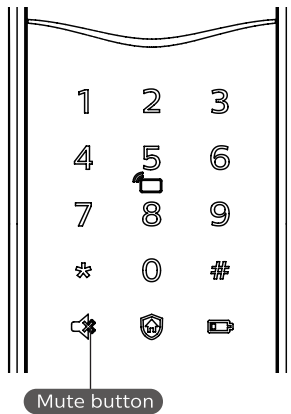

**Function:**  
Use only one button to mute the lock by turning off the voice guide. Applicable to the scenes where you don't want to disturb your family.

**How to use:**  
1. **Mute:** When the system is awake, long press the [Mute] button for 2 seconds to enter one-time mute mode. The button will glow green.  
2. **Unmute:** When the system is awake, long press the [Mute] button for 2 seconds to restore the voice guide. The button will glow white.

## Outside forced lock function

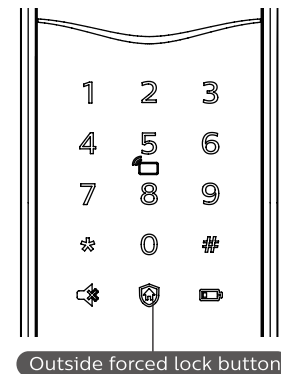

**Function:**  
Unlocking from inside will trigger an alarm.

**Use:**  
After the door is successfully locked, long press the functional button for 2 seconds to enter the outside forced lock mode.

**Attention**  
Enabling the outside forced lock function will not affect unlocking from outside.

## Deadlock from inside

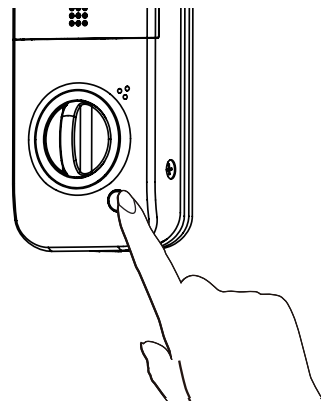

After the door is successfully locked, long press the Close button. There will be a voice prompt of "Inside deadlock enabled".

**Attention**  
When the door is inside dead locked, the digital functions of the outside escutcheon will be disabled. If the system is waken up manually, the keypad will display the combination of "15937 (X-shape)" and there will be a voice prompt saying that the inside deadlock has been enabled. To disable inside deadlock, you can either get your master PIN code verified on the outside escutcheon or unlock from inside.

## 7 Meanings & Use of indicators

### Lock status indicator



**Colors of the light and the corresponding meanings:**

**Blue:** After the system wakes up, the light will glow blue, indicating that you can operate the lock.  
**Green:** After the door is unlocked, the light will glow green, indicating that the door has been opened.  
**Red:** After the door is locked, the light will glow red, indicating that the door has been closed.

### Low battery indicator

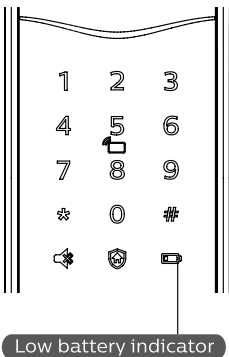

**Colors of the light and the corresponding meanings:**

**Red:** After waking up, the system will run an automatic examination on the battery voltage. If the voltage is too low, the light will flash in red and there will be a voice prompt of "Low battery. Please replace all batteries".

## Outside forced lock indicator



Outside forced lock indicator

Colors of the light and the corresponding meanings:

**White:**

1. When the door is locked, the light will be lighted up, indicating that you can enable the outside forced lock function.
2. If you have enabled the outside forced lock function, the light will be lighted up after the system wakes up, indicating this function is under use.

## Mute mode indicator

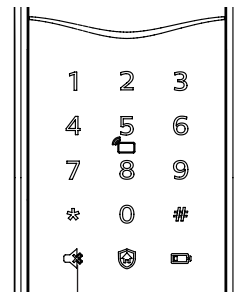

Mute mode indicator

Colors of the light and the corresponding meanings:

1. **White:** Indicates the mute mode is off.
2. **Green:** Indicates the mute mode is on.

## 8 Troubleshooting

### Types of alarms and alarm modes

#### Inside unlocking alarm under outside forced lock mode

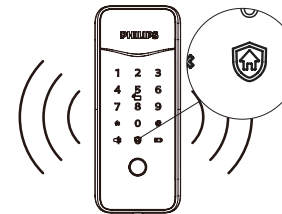

**Triggering:** If the lock is under outside forced lock mode, unlocking from inside will trigger the alarm.

**Alarm mode:** Continuous repeated alarms.

**Turning off:** The alarm can be turned off by a successful verification of any type.

#### Low battery alarm, remind you to replacing the batteries in time

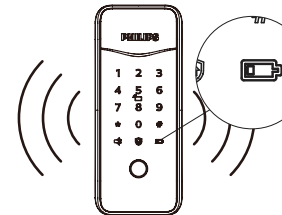

**Triggering:** After waking up, the system will run an automatic examination on the battery voltage. If the voltage is too low, the lock give an alarm and a voice prompt of "Low battery. Please replace all batteries".

**Alarm mode:** A voice prompt of "Low battery. Please replace all batteries".

**Turning off:** The alarm will be automatically turned off.

#### Anti-prying alarm



**Triggering:** The door is pried open and the sensor latch bolt pops up.

**Alarm mode:** Continuous repeated alarms.

**Turning off:** The alarm can be turned off automatically or by a successful verification.

### Anti-dismantling alarm

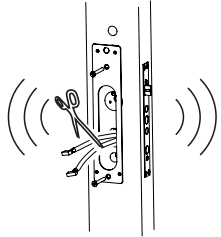

**Triggering:** The connecting cable of the outside and inside escutcheons are disconnected.

**Alarm mode:** Continuous repeated alarms.

**Turning off:** The alarm can be turned off by cutting off the power supply.

### How to apply an emergency power supply

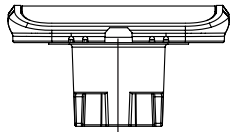

Emergency power interface

When the battery voltage is insufficient, and the door cannot be opened from the outside, you can power up the lock through the Micro USB interface by using a 5V power bank as an emergency power supply. After opening the door lock, please replace the batteries immediately.

### How to replace batteries

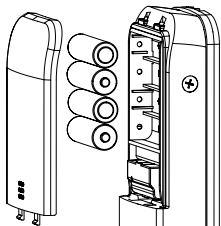

The lock is powered by four 1.5V alkaline batteries. The battery cabinet is located at the upper part of the inside escutcheon. Push the battery cover upwards to remove the batteries.



Philips and the Philips Shield Emblem are registered trademarks of Koninklijke Philips N.V. and are used under license. This product has been manufactured by and is sold under the responsibility of Shenzhen Conex Intelligent Technology Co., Ltd., and Shenzhen Conex Intelligent Technology Co., Ltd. is the warrantor in relation to this product.

Version:2.0